

To make the Spectroscope, cut along the dotted lines and fold and paste as shown

Detailed and illustrated assembly instructions are available at:
http://www.iucaa.ernet.in/~scipop/Obsetion/spectro/crd_brd_spectro.htm

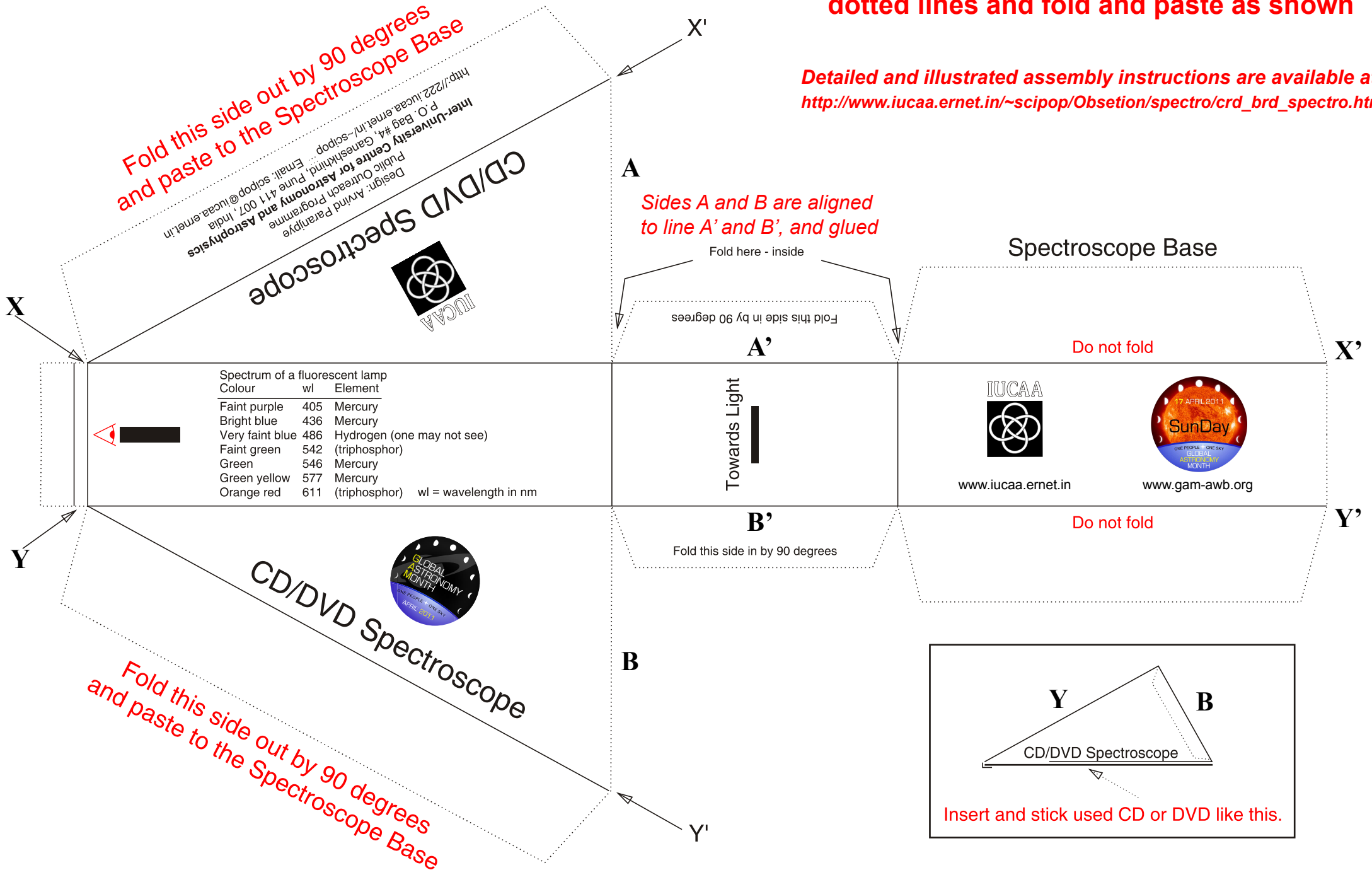

Fold this side out by 90 degrees and paste to the Spectroscope Base

Sides A and B are aligned to line A' and B', and glued

Spectroscope Base

Do not fold

Do not fold

